

2026 Marin Stinson 1 LS - Geometrical Chart

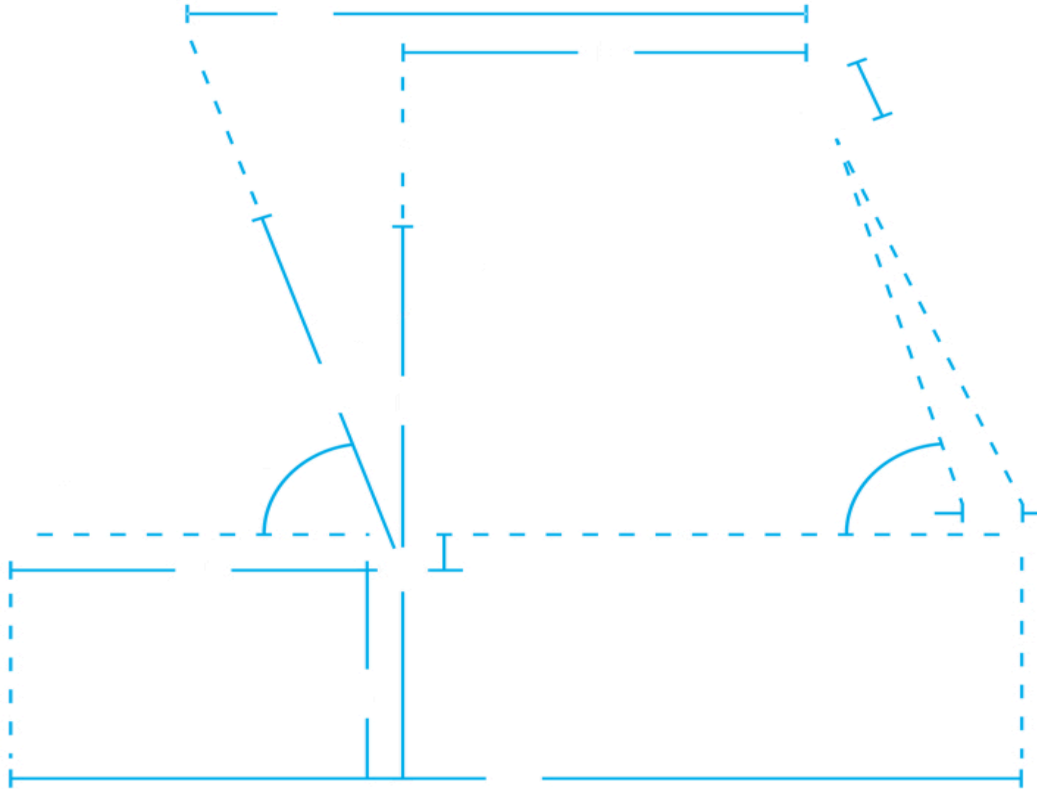

Geometry	S	M	L
A Stack	641	660	678
B Reach	330	340	350
C Headtube angle	68.5°	68.5°	68.5°
D Headtube length	210	230	250
E Seattube length	382	406	444
F Seattube angle	67°	67°	67°
G Toptube effective	602	620	640
H Bb height	280	280	280
I Bb drop	68	68	68
J Chainstay	485	485	485
K Wheelbase	1079	1096	1113

Geometry	S	M	L
L Standover height	393	393	393
M Fork offset	40	40	40
N Seatpost diameter	30.9	30.9	30.9
O Handlebar width	700	700	700
P Stem length	45	45	45
Q Crank length	170	170	170