

# CeramicSpeed Bottom Bracket ALPHA

## Spacer overview for SRAM DUB

ROAD/ GRAVEL	Frame width (mm)	Standard (width 93 mm)		Wide (width 98 mm)	
		Non-drive side	Drive side	Non-drive side	Drive side
BB30	68	0 mm	3 mm	3 mm	5 mm
BB86	86,5	0 mm	3 mm	3 mm	6 mm
BBright	79	0 mm	3 mm	2,5 mm	5,5 mm
BSA	68				
EVO386	86,5				
ITA	70				
PF30	68				
T45 (Colnago)	82,5				
T47	68				
T47	86,5				
T47 (Trek)	85,5				
T47a	77				

MTB	Frame width (mm)	Standard (width 100 mm)		Wide (width 105,5mm)	
		Non-drive side	Drive side	Non-drive side	Drive side
BB30	73	0 mm	3 mm	3 mm	5 mm
BB92	91,5	0 mm	1 mm	0 mm	3 mm
BSA	73	1 mm	4 mm	4 mm	6,5 mm
PF30	73				
T47	73				
T47(Factor)	88,5	0 mm	3 mm	2,5 mm	5,5 mm

Width	Spacers
1 mm	1 mm
2,5 mm	2,5 mm
3 mm	3 mm
4 mm	1 + 3 mm
5,5 mm	3 + 2,5 mm
6,5 mm	1 + 2,5 + 3 mm

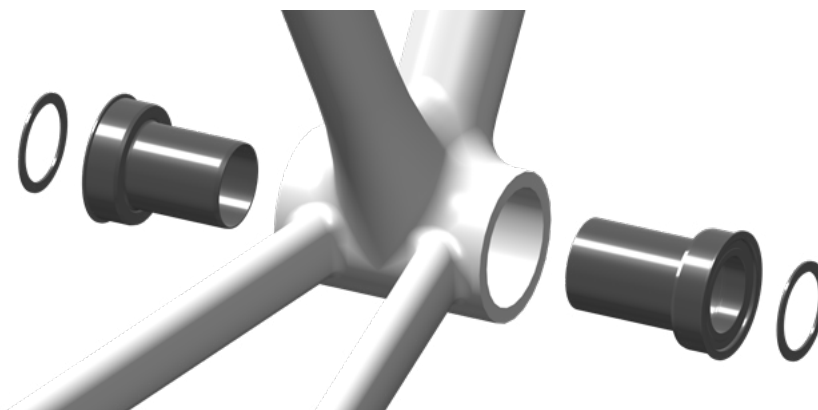

Due to manufacturing variances and arrangements between frames and cranks, it is advised to always confirm setup alignment and clearances after appropriately torquing the cranks and before riding. This spacer guide is only a reference for standard arrangements and may require individual adjustments based on the chosen combination of components.