

SHIMANO 105 SPD-SL Pedals PD-R7000

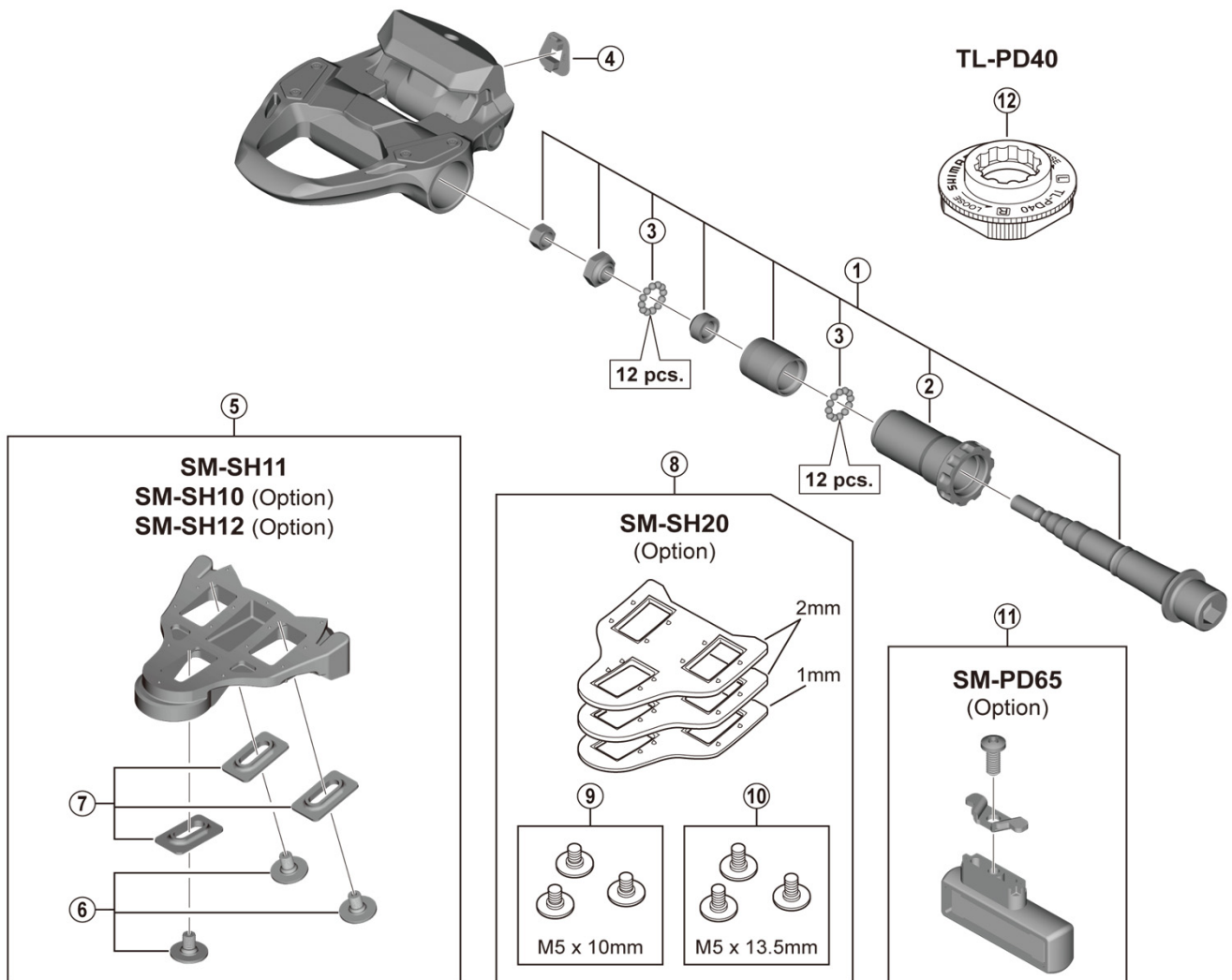

ITEM NO.	SHIMANO CODE NO.	DESCRIPTION	INTERCHANGEABILITY	
			PD-R8000	PD-5800
1	YL8G98010	Pedal axle assembly (right / B.C.9/16" x 20T.P.I.)		
	YL8G98020	Pedal axle assembly (left / B.C.9/16" x 20T.P.I.)		
2	YL8G98030	Lock bush (right)		
	YL8G98040	Lock bush (left)		
3	Y41N98030	Steel ball (3/32") 62 pcs.	A	A
4	Y42U10300	Indicator	A	A
5	Y42U98010	SM-SH11 Cleat set (self-aligning mode / pair / M5 x 8 mm)	A	A
	Y42U98020	SM-SH10 Cleat set (fixed mode / pair / option / M5 x 8 mm)	A	A
	Y40B98140	SM-SH12 Cleat set (front center pivot / pair / option / M5 x 8 mm)	A	A
6	Y42U98080	Cleat fixing screw (M5 x 8 mm / 6 pcs.)	A	A
7	YL8898060	Cleat washer (silver / 6 pcs.)	A	A
8	Y40B98150	SM-SH20 Cleat spacer set (Option)	A	A
9	Y42U98070	Cleat fixing screw (M5 x 10 mm) 6 pcs.	A	A
10	Y42U98060	Cleat fixing screw (M5 x 13.5 mm) 6 pcs.	A	A
11	Y40R98110	SM-PD65 Reflector unit (pair/option/AS compatible)	A	A
* 12	Y42A09000	TL-PD40 Lock bush tool		

A: Same parts.

B: Parts are usable, but differ in materials, appearance, finish, size, etc.

Absence of mark indicates non-interchangeability.

Specifications are subject to change without notice.

Feb.-2021-4337A

© Shimano Inc. I

SHIMANO